

**SUBDIVISION PLAT**  
**FOR**  
**Ellsworth Estates**  
 Puckerbrush Farm Road, Campton, NH  
 6 Lots  
 Developer: BPV Development Co., LLC  
 7 Fondue Avenue  
 Thornton, NH 03223  
 Deed: Book 3059, Page 0931  
  
 Scale 1" = 100'  
 Zone: FC (Forest Conservation)  
 Tax Map # 2-02-12 Date: March, 2005  
 Theodolite-EDM Survey by Mountain Mapping  
 Route 3  
 Campton, NH

NH Wetlands Bureau Permit #2005-00086

**Plan References**

1. "Survey for Priscilla A. & Robert E. Phipps, Puckerbrush Farm Road, Campton, NH" dated April, 1985 by John French. Grafton County Registry of Deeds Plan #3419.
2. "Ellsworth Heights Subdivision, Campton, NH" for Dean Giftos, dated November, 1988 by Jesseman Associates, PC. Grafton County Registry of Deeds Plan #5610.
3. "Lot Line Adjustments at Ellsworth Heights, Puckerbrush Farm Road, Campton, NH" dated October, 1999 by Mountain Mapping. Grafton County Registry of Deeds Plan #9902.

**Note:**

Greenbelt areas held subject to certain easement rights as set forth in the Declaration.

2-2-13

Approved by the

CAMPTON PLANNING BOARD

Chairman \_\_\_\_\_

Secretary \_\_\_\_\_

Date \_\_\_\_\_

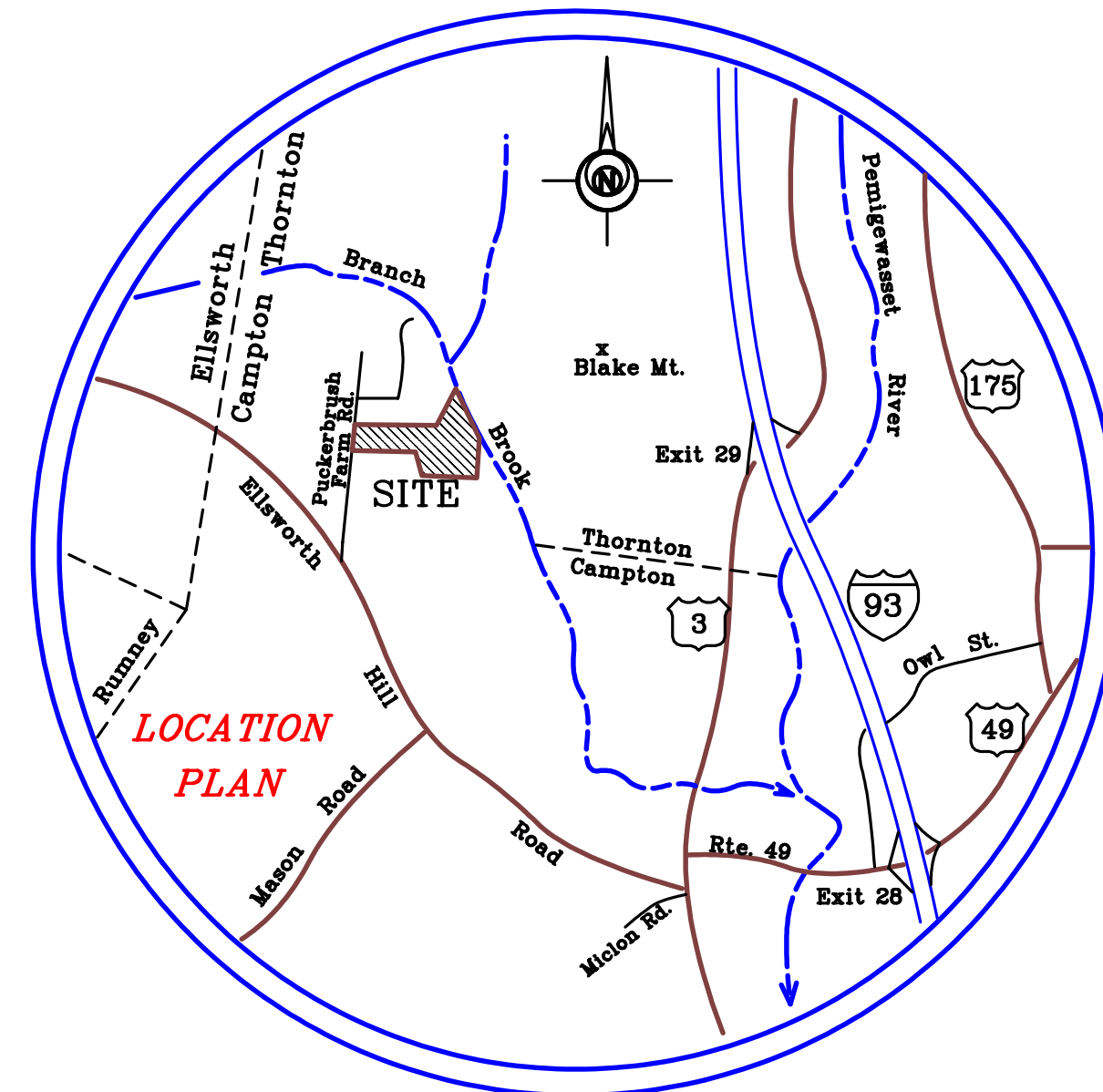

**Legend**

- iron pipe or pin
- calculated point
- granite or concrete monument
- ⊕ utility pole
- stone wall
- intermittent stone wall
- ⊙ test pit
- property line setback
- treeline
- wet area

